

USE AND MAINTENANCE MANUAL

OMEGA

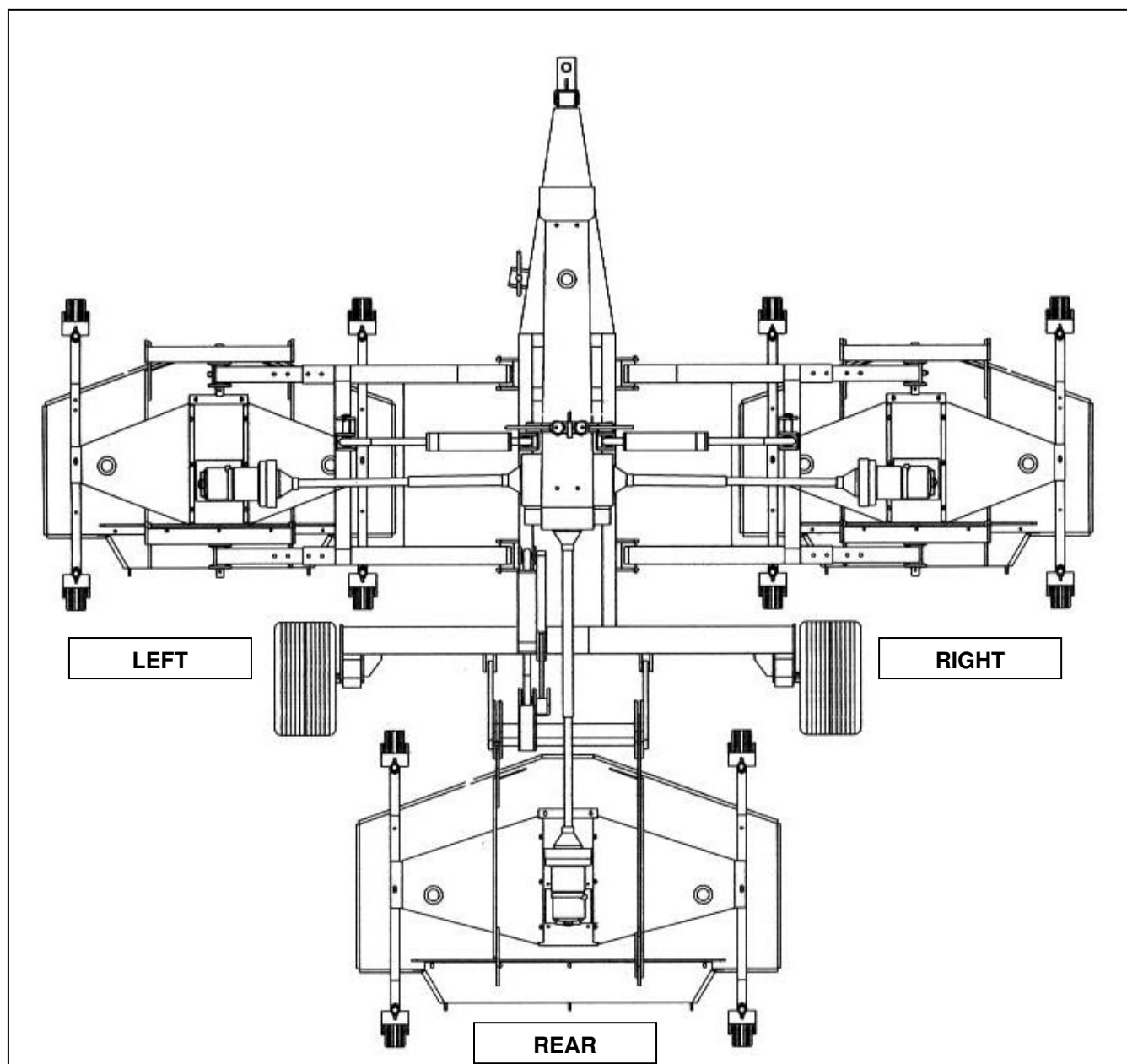

PREFACE

This manual is an integral part of the machine.

It must always accompany the machine and be kept within reach of the operator.
The enclosures mentioned are an integral part of this manual.

The purpose of this manual.

This manual gives information for the correct and safe use of the machine.
The owner must read this manual carefully before work with the machine.

Responsibility of the owner

The owner is responsible for accidents or damages caused to people or things due to negligence in following the instructions in this manual.

Assistance in using this manual

Explanations: contact the dealer.

Request for additional copies of the manual: in case of loss or wear and tear, or in case one wants the manual in a different language, the customer should ask the dealer or manufacturer.

Pay attention to the warning signals



<Danger>: indicates a situation that is potentially dangerous which, if not avoided, will cause death or serious damage.



<Warning>: indicates a situation that is potentially dangerous which, if not avoided, will cause death or serious damage.



<Caution>: indicates a situation that is potentially dangerous which, if not avoided, can cause minor to moderate damage, or it indicates to be careful about an unsafe procedure.

<Important> : indicates instructions that must be followed precisely in order to avoid damage to the product, process or environment.

<Note>: indicates supplementary information.

DESCRIPTION

FUNCTION OF USE

The machine gives grass a professional cut. The grass is first raised, then cut with precision and discharged in the rear side along the width of discharge.

It perfects any preliminary cut.

The machine is formed by 3 cutting components; each one moves in the soil with 4 pivotal wheels; each component is free in the movements to adjust itself to the soil.

Each component takes the motion through wide angle joints by a gear box with 4 ways driven by the PTO of the tractor.

The 3 components follow perfectly the line of the soil making a uniform cutting action of high quality.

PERFORMANCES

The frame, where the cutting components are connected, permits to raise the 3 mowers for the transport, through a hydraulic integrated system.

The pivotal wheels of the components permit the best control both on forward gear and reverse gear; the wheels have dimensions so as not to damage the turf.

The height of the cut is adjustable from 1 to 4 inches through distance washers that can be inserted in the vertical pivotal axles.

The components always have their 4 wheels on the ground.

The cutting components of the machine have the "central" lubrication of the blade-supports; in this way, the operator can see and approach immediately the lubrication points.

PERFORMANCES LIMITS

- Maximum forwarding speed: 5 m.p.h.
- Speeds greater than the maximum can compromise the condition of the machine, the quality of the work and the safety of the operator.
- Maximum power applicable to the gear box: 41 kW \pm 5% with 540 RPM.
- Superior power to which is indicated can damage irreparably the transmission gear box; especially during heavy works.

STANDARD EQUIPMENT

- Main clutch PTO shaft.
- Mowers with rubber wheels.
- Centralized lubrication.
- Anti scalp roll.

VARIANTS & OPTIONS

- Mowers with rubber wheels ϕ 310.
- Mowers with pneumatic wheels ϕ 330.
- Main wide angle clutch PTO shaft.
- Mulching kit.

SAFETY DEVICES

The machine is equipped with a lock device with a manual unhooking that keep the casual descent of the 3 cutting components during the transport and maintenance operations.

TECHNICAL SPECIFICATIONS

DRAW-HOOK OF THE TRACTOR

The diameter of the hitch pin must not be less than 30 mm. the pin must be produced in C 40 steel or similar and must be equipped to the extremities of a hole to apply the safety spring pin.

CHARACTERISTICS PER MODEL

Model	Type	Mowers		Cutting width		Cutting height		Blade tip speed		Blade speed		Blade number	
		Side	Rear	Ft	mm	Inch	mm	F/M	m/s	RPM	N°		
OMEGA	11	2x48"	1x48"	132"	3300	1÷4	25÷100	13773	4225	3250	(3x3) =9		
	12	2x48"	1x60"	144"	3600	1÷4	25÷100				(3x3) =9		
	14	2x60"	1x60"	168"	4200	1÷4	25÷100	13718	4208	2630	(3x3) =9		
	15	2x60"	1x72"	180"	4500	1÷4	25÷100				(3x3) =9		
	17	2x72"	1x72"	204"	5100	1÷4	25÷100	14083	4320	2250	(3x3) =9		
	19	2x72"	1x93"	222"	5650	1÷4	25÷100				(3x2)+5 =11		
21	2x85"	+1x93"	2502	6350	1÷4	25÷100	16104	80	2125	(3x2)+5 =11			
Model	Type	Mowers		Power consumption kw RPM		Storage Width Length				Work speed		Weight	
		Side	Frontal	Central	Secondary	Inch	m	Inch	m	km/h	Mph	Lbs	Kg
OMEGA	11	2x48"	1x48"	41+540	16	94"	2,40	141"	3,60	8	5	2222	1010
	12	2x48"	1x60"			94"	2,40	141"	3,60	8	5	2244	1020
	14	2x60"	1x60"	41+540	16	94"	2,40	147"	3,75	8	5	2332	1060
	15	2x60"	1x72"			94"	2,40	147"	3,75	8	5	2376	1080
	17	2x72"	1x72"	41+540	16	96"	2,45	153"	3,90	8	5	2508	1140
	19	2x72"	1x93"			96"	2,45	153"	3,90	8	5	2684	1220
21	2x85"	+1x93"	41+540	16	98"	2,50	153"	3,90	8	5	2860	1300	

SAFETY INFORMATIONS

GENERAL REGULATIONS

- ❑ Only work in daylight.
- ❑ To prevent damage due to lunch of objects or parts of blades, before to start job be sure that any persons or animals should be in the radius of 50 meters from the machine.
- ❑ Wear long pants and heavy shoes.
- ❑ The protections are integral part of the machine: always work with the protections.
- ❑ Make sure that the 4 wheels of all components be adjusted to the same cutting height.
- ❑ Pay attention to the soil: make sure that are not stones, sticks, iron wires, etc...
- ❑ Pay attention using the machine on slopes: proceed to the maximum slope and never work in slanting direction.
- ❑ Before leaving the driver's seat, turn off the engine and disengage the transmission engine-shaft.
- ❑ Check immediately the machine if it touches foreign objects.
- ❑ Check immediately the machine if there are unusual strong vibrations.
- ❑ Change quickly defective parts.

SAFETY RESTRICTIONS

Children and people who are not familiar with these instructions must not be permitted to use the machine. Local regulations can restrict the use of the machine in accordance to the age.

SAFETY SIGNS ON THE MACHINE

In this section, the safety signs on the machine are reproduced and explained.

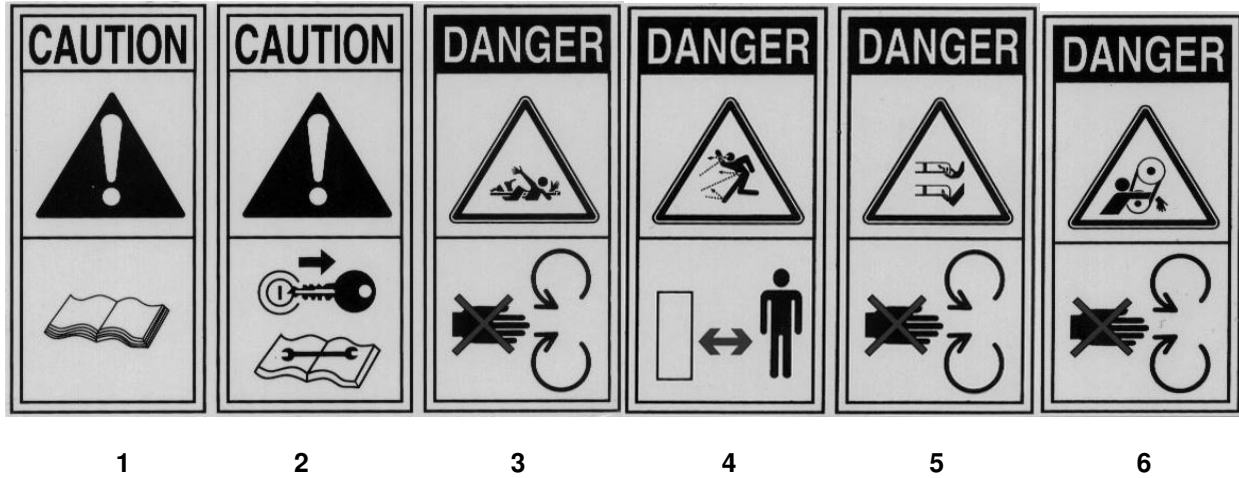

1. Read the operator manual.
2. Disconnect the tractor key before maintenance and repair operations.
3. Stay at safety distance from blades when machine is moving.
1. Danger of flying objects. Stay at safety distance.
4. Stay at safety distance from blades when machine is moving.
5. Stay at safety distance from blades when machine is moving.

The safety signs on the machine must always be legible.

In case of damage, the labels of the signs must be substituted.

In the case of the substitution of machine parts that have safety signs, the signs must be replaced.

Supplying of new safety labels and the application procedure

Contact your dealer to receive new safety labels with instructions for application.

ASSEMBLING INSTRUCTIONS

PARTS LIST		
POS.	DESCRIPTION	Q.TY'
1	MAIN FRAME	1
2	REAR HUB	2
3	REAR WHEEL	2
4	LIFTING JACK	1
5	RIGHT SIDE CONNECTION FRAME	1
6	LEFT SIDE CONNECTION FRAME	1
7	REAR CUTTING COMPONENT	1
8	RIGHT SIDE CUTTING COMPONENT	1
9	LEFT SIDE CUTTING COMPONENT	1
10	CROSS BAR WHEEL CASE	6
11	MOWER WHEEL GROUP	12
12		
13	CASING	3
14	SIDE CONNECTION BRACKET	4
15	SIDE CONNECTION BEAM	4
16	REAR CONNECTION FRAME	1
17	REAR END STROKE ROD	2
18	HYDRAULIC RAM	3
19	SIDE SAFETY DEVICE	1
20	REAR SAFETY DEVICE	1
21	SIDE END STROKE ROD	2
22	SIDE HOMOKINETIC CARDAN JOINT	2
23	REAR HOMOKINETIC CARDAN JOINT	1
24	POWER CARDAN JOINT	1
25	POWER DRIVING GROUP CARTER	1
26	DRAW-HOOK	1
27	SIDE HYDRAULIC PIPE	2
28	REAR HYDRAULIC PIPE	1

- ❑ OMEGA is delivered disassembled in the parts listed in the **PARTS LIST**, for transport necessities.
- ❑ All bolts, pins, safety clips pins, the click pins, the distance washers, are supplied already inserted in their seats.
- ❑ For a perfect assembling operation of the mower, must refer to the assembling scheme and to the assembling instructions showed in this manual.
- ❑ To avoid problems, follow scrupulously the succession of the steps indicated in the instructions utilizing only the bolts and accessories supplied with the machine.
- ❑ The assembling of the machine doesn't request any special equipment, during assembling steps; follow the normal anti-labor accident regulations.

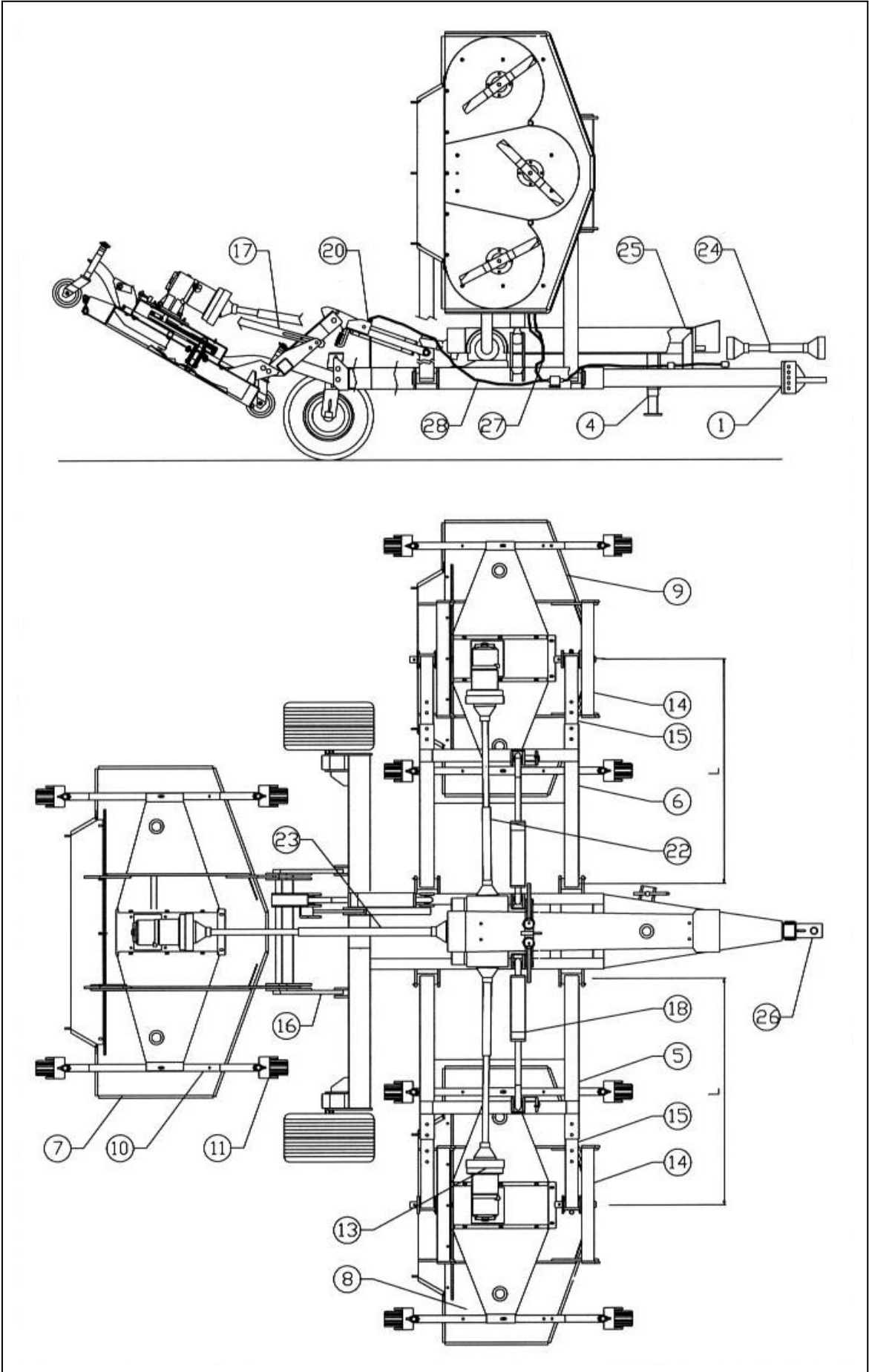



TABELLA "B"

MODELLO	TAGLIERBA 8+9	TAGLIERBA 7	L mm
OMEGA 11	PRM 120	PRM 120	965
OMEGA 12	PRM 120	PRM 150	965
OMEGA 14	PRM 150	PRM 150	1115
OMEGA 15	PRM 150	PRM 180	1265
OMEGA 17	PRM 180	PRM 180	1415
OMEGA 19	PRM 180	XRM 235	1690

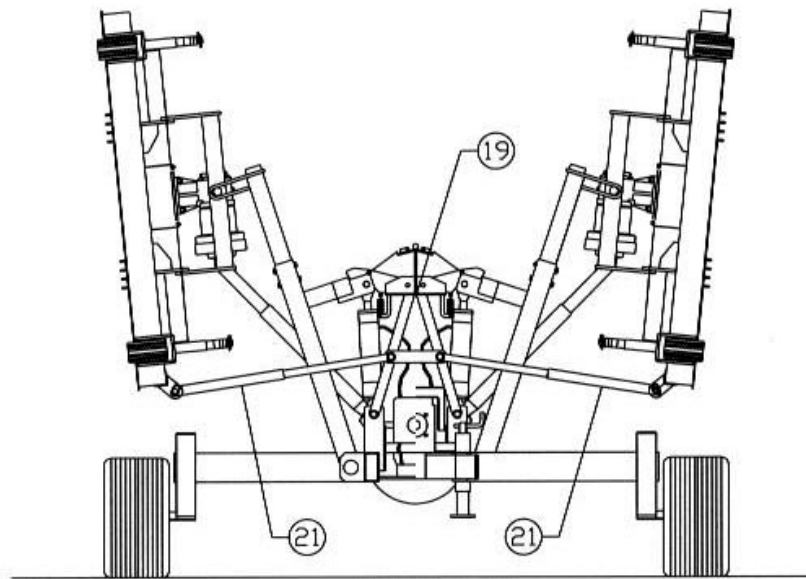

TABELLA "A"

GRUPPO RUOTA 11	REGOLAZIONE MOZZO 2
GOMMA	POSIZIONE 1
PNEUMATICA	POSIZIONE 2

1. MAIN FRAME "1" ASSEMBLING

- a) Insert the **REAR HUB "2"** in the fitting fork found in the rear right side from the **MAIN FRAME "1"**, adjust it the height on **POSITION 1** if the cutting components are equipped with rubber wheels, or in **POSITION 2** if the cutting components are equipped with pneumatic tires (see **TABLE "A"** on reference scheme), insert the screws and lock them with nuts.
- b) Insert the **REAR WHEEL "3"** in the hub; fix it with the special nut.
- c) Repeat steps "a" and "b" on the rear left side of the **MAIN FRAME**.
- d) Insert the **LIFTING JACK "4"** in the seat found in the front of the **MAIN FRAME**, insert the screw and lock it with the nut.
- e) Insert the **RIGHT SIDE CONNECTION FRAME "5"** in the special forks found on the right side of the **MAIN FRAME** orienting it with the hitch fork hydraulic ram oriented to the top, insert the pins and lock them with the nuts.
- f) Insert the hitch welded at the bottom of the **HYDRAULIC RAM "18"** in the special fork found on the right side of the **MAIN FRAME**. Insert the pin but not screw the fixing nut.
- g) Repeat steps "e" and "f" on the left side of the **MAIN FRAME** utilizing the **LEFT SIDE CONNECTION FRAME "6"**.
- h) Insert the **FRONT SIDE SAFETY DEVICE "19"** on the fixing pins of the hydraulic rams orienting them with the guides side end stroke rod oriented to the front of the frame, lock it utilizing the nuts described in the step "f".
- i) Insert the hitch screwed to the hydraulic ram stem in the special fork found on the right connection frame, insert the pin and lock it with the safety clips. Extend the ram until carry the frame in horizontal position.
- j) Repeat step "i" on the left side of the **MAIN FRAME**.
- k) Insert the **REAR CONNECTION FRAME "16"** in his special forks found in the rear side of the main frame orienting it with the hitch fork hydraulic ram oriented to the up, insert the pins and lock them with the nuts.
- l) Insert the hitch welded on the bottom of the **HYDRAULIC RAM "18"** in his special fork found on the left rear side of the main frame. Insert the pin but don't lock the fixing nut.
- m) Insert the **REAR SAFETY DEVICE "20"** on the fixing pin of the hydraulic ram orienting it with the fixing bracket oriented to the low, lock it utilizing the nut described in the step "l" and the locking screw of the bracket.
- n) Insert the hitch locked to the hydraulic ram stem in his special fork found on the rear connection frame, insert the pin and lock it with the safety clips. Extend the ram until carry the frame in horizontal position.
- o) Connect the unhooking cable to the rear safety device through the special spring-clip.
- p) Remove from the connector situated in the right top side of the hydraulic ram the protection cap; lock the terminal connector of the **SIDE HYDRAULIC PIPE "27"** to the ram connector.
- q) Repeat step "p" on the left of the machine.
- r) Remove the protection cap from the connector situated in the up side of the hydraulic ram; lock the terminal connector of the **REAR HYDRAULIC PIPE "28"** to the ram connector.

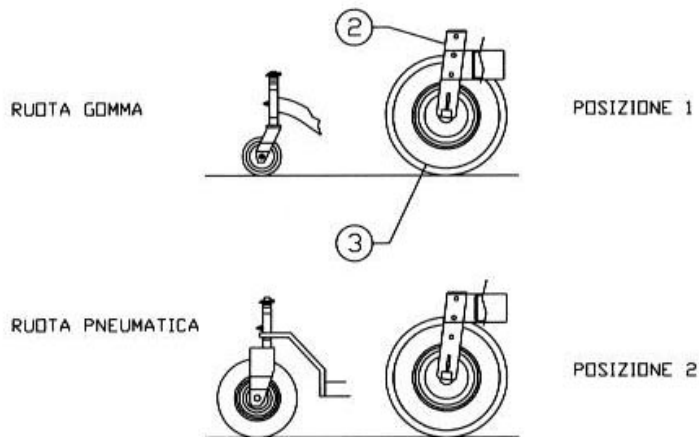
- s) Accordance with the height of the tractor draw-hook and to permit to the machine to work the most parallel to the ground, insert the screws and lock the nuts.

2. MOUNTING RIGHT CUTTING COMPONENT "8"

- a) Insert the **CROSS BAR WHEEL CASE "10"** in the seat found on the right of the **RIGHT CUTTING COMPONENTS "8"**, insert the screws and lock them with the nuts.
- b) Insert in the front and rear hub of the right wheel-support cross bar the **MOWER WHEEL GROUP "11"**, insert the distance washers, the click pin and lock.
- c) Repeat steps "a" and "b" on the left side of the cutting component.
- d) Insert the **SIDE CONNECTION BRACKET "14"** in the seat predisposed in the front side of the cutting component, insert the screws and lock them with the nuts.
- e) Repeat step "d" in the rear side of the cutting component.
- f) Mount the **CASING "13"** in the gear box.

3. MOUNTING LEFT CUTTING COMPONENT "9"

- a) Repeat the operations from "a" to "f" described in the phase "2".

4. MOUNTING REAR CUTTING COMPONENT "7"

- a) Repeat steps from "a" to "c" and step "f" described in the phase "2".

5. MOUNTING RIGHT CUTTING COMPONENT ON MAIN FRAME

- a) Insert the **SIDE CONNECTION BEAM "15"** with the seat oriented to the low in the pin of the front connecting bracket, insert the pin and lock with the safety clip.
- b) Repeat step "a" on the rear bracket.
- c) Insert the two connecting beams in their seats of the connecting frame fixed in the right side of the main frame, adjust the inter-axle "L" following the indications on the table "B", insert the screws and lock them with the nuts.
- d) Insert the **SIDE END STROKE ROD "21"** in the right guide of the side safety device. Insert the hitch on the other end of the same rod into the fork found on the left side of the right cutting component. Insert the pin and lock it with the safety clips.

6. MOUNTING LEFT CUTTING COMPONENT ON MAIN FRAME

- a) Repeat steps "a" to "d" described in phase "5".

7. MOUNTING REAR CUTTING COMPONENT ON MAIN FRAME

- a) Insert the hitches found on the front of the rear connecting frame. Insert the screws and lock them with the nuts.
- b) Insert the head holes of the **REAR END STROKE ROD "17"** into the forks found on the rear side of the rear connecting frame. Insert the screws and lock them with nuts.
- c) Insert the free ends of the rear end stroke rod into the forks on the upper side of the rear cutting component. Insert the screws and lock them with nuts.

8. FINAL ASSEMBLING

- a) Insert the end of the **SIDE HOMOKINETIC CARDAN JOINT "22"**, directioning it as in the diagram, in the shaft located on the right side of the gear box mounted on the main frame. Insert the other end of the PTO joint in the shaft of the angular gear box mounted on the right cutting component.
- b) Repeat step "a" on the left side of the machine.
- c) Insert the end of the **REAR HOMOKINETIC PTO JOINT "23"**, directioning it as in the diagram, in the shaft located on the rear side of the gear box mounted on the main frame. Insert the other end of the PTO joint in the shaft of the angular gear box mounted on the rear cutting component.
- d) Position the **POWER DRIVING GROUP CARTER "25"** on the main frame. Insert the screws and lock them with nuts.

9. GREASING AND LUBRICATION

In accordance with transportation regulations the machine comes without oil or grease. Therefore it must grease and lubricated before using.

To do this see the section "**MAINTENANCE INSTRUCTIONS**" points "1-2-3-4" page 16 and 17.

1. BEFORE BEGINNING WORK

- a) Check oil level in gear boxes. (See page 17 point "4")
- b) Hook the machine to the tractor.
- c) Connect the hydraulic system of the machine to that of the tractor by means of the quick coupling (fast clutch).
- d) Make sure that the safety stops are hooked and the cutting components raised.
- e) If necessary regulate the cutting height, referring to diagram "A", as follows:
 - 1. Remove the spring pin from the pivotal axle.
 - 2. Move the distance washer above or below the hub.
 - 3. Reposition the spring pin.
 - 4. Make sure that the same cutting height is set up on each wheel of all cutting components.

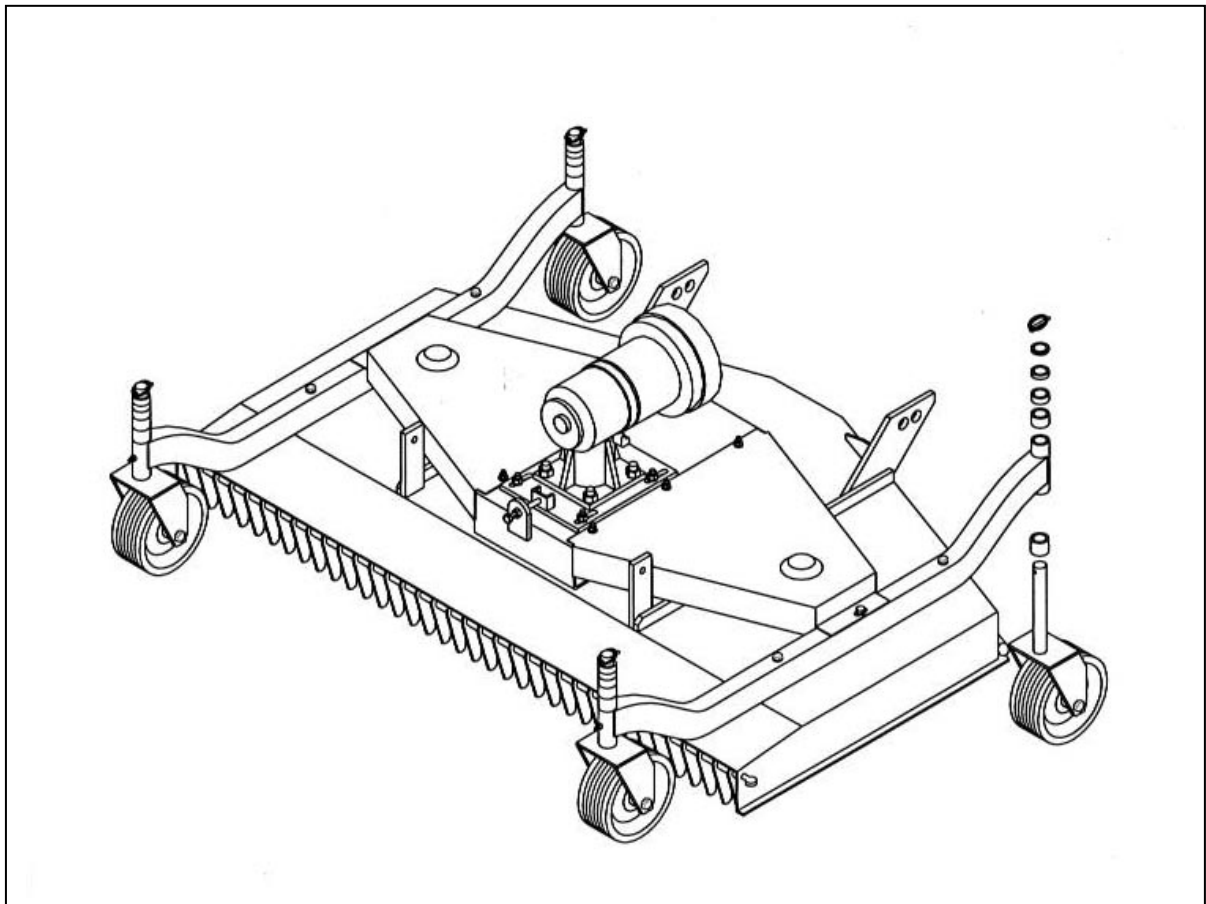

- f) Connect the PTO shaft to machine P.T.O.
- g) Check that the PTO chain is attached to the dragging hook so as to prevent the protection sheath of the PTO from rotating.

2. TO BEGINNING WORK

- a) Keep people, animals and things at least 15 meters from the machine. Start the engine and lower the 3 cutting components as follows:
- b) Pull the cable to free the side safety hooks. Activate the hydraulic switch and wait until the 2 side cutting components are touching the ground.
- c) Pull the cord again to free the rear safety hook. Activate the hydraulic switch and wait until the rear cutting component is touching the ground.
- d) Insert the PTO gradually bring it to 540 r.p.m.
- e) Begin cutting.

3. AT THE END OF WORK

- a) Stop the tractor.
- b) Disconnect the PTO.
- c) Disconnect the PTO joint.
- d) Raise the 3 cutting components.
- e) Make sure that the safety hooks are in the correct position.
- f) Clean the under sides of the cutting components to remove deposits of grass and dirt. Use a wooden spatula so as not damage the paint.
- g) Proceed to a visual check of the blades to make sure if there are damages.

MAINTENANCE INSTRUCTIONS

On diagram "A" the maintenances are indicated with their terms to effect on the machine.
 Not follow the scheduled terms can compromise the functionality of the machine and in this case the warranty is not applicable.

DIAGRAM "A" SCHEDULED MAINTENANCE

	FIRST START	AFTER 10 H.	EACH 30 H.	EACH 500 H.	END SEASON	BEGINNING WORK	END WORK
MACHINE	Greasing		Greasing		Cleaning Greasing		Cleaning
OIL	Put	Check level	Check level	Substitution		Check level	
SCREWS		Locking	Locking				
BLADES			Check Sharpness Balance				Check Cleaning
BELTS		Check tension	Check tension	Substitution			

1. FRAME GREASING

All the greasing points, both those situated and both centralized, are equipped with greaser HYDRAULIC TYPE MODEL "A" UNI 7663.

To grease use only MULTIFUNCTIONAL GREASE LITHIUM BASED Type NLGI 2.

Refer to the scheme; the greasing points are the points "A".

Greasing operation must be made at the terms scheduled on diagram "A".

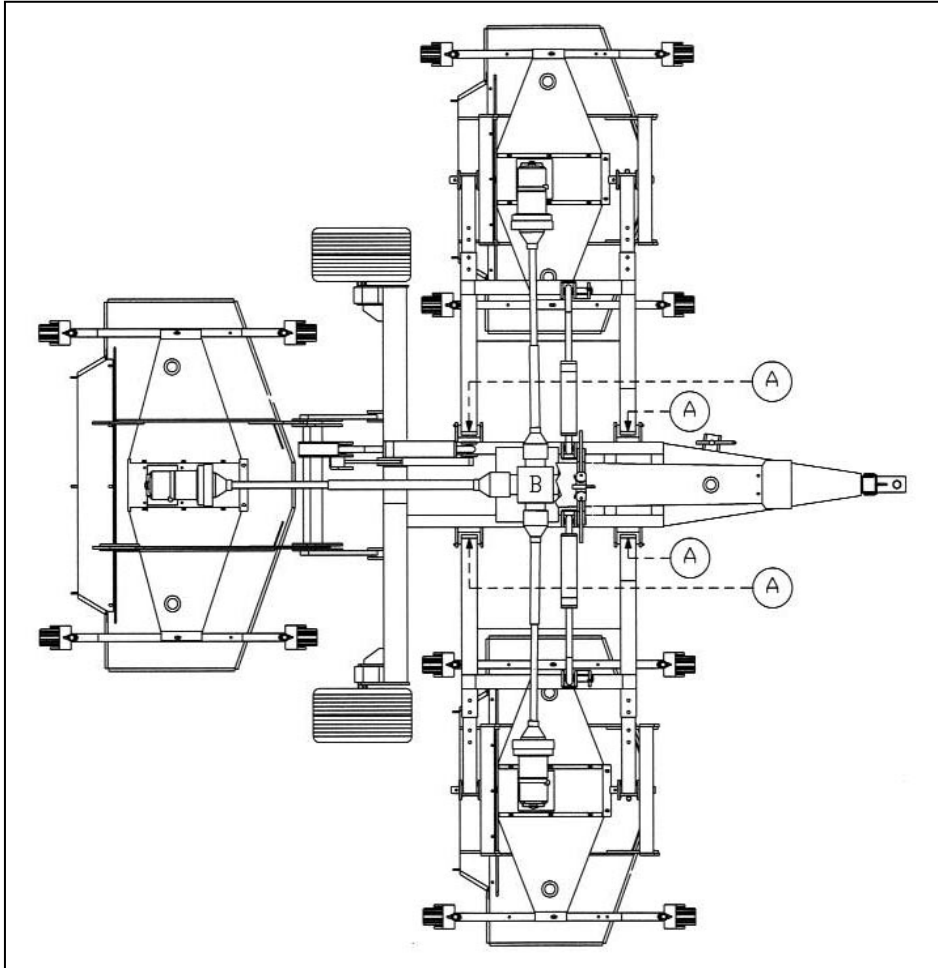

2. FRAME GEAR BOX OIL SUBSTITUTION

To change oil use only OIL SAE 90 EP, oil capacity of angular gear box is 0,5 L.

Oil change operations must be made at the terms scheduled on diagram "A".

a) To change oil in gear box "B" locate on main frame, operate as follow :

1. Remove safety protection.
2. Unscrew the plug locate on the top of gear box.
3. Unscrew discharge plug locate on lower part of gear box and take out oil.
4. Screw discharge pug.
5. Fill new oil in suitable type and quantity.
6. Screw the plug.
7. Put in place safety protection.

3. MOWERS GREASING

All the greasing points, both those situated and both centralized, are equipped with greaser HYDRAULIC TYPE MODEL "A" UNI 7663.

To grease use only MULTIFUNCTIONAL GREASE LITHIUM BASED Type NLGI 2.

Refer to diagram, greasing points are points "C" one per each wheel, point "D" located on a bracket in front of gear box bracket.

Greasing operation must be made at the terms scheduled on diagram "A".

4. MOWERS OIL CECK – OIL SUSTITUTION

To fill and to change oil use only OIL SAE 90 EP, oil capacity of angular gear box is 0,5 L.

Oil fills and oil change operations must be made at the terms scheduled on diagram "A".

a) To check oil level in angular gear box operate as follows :

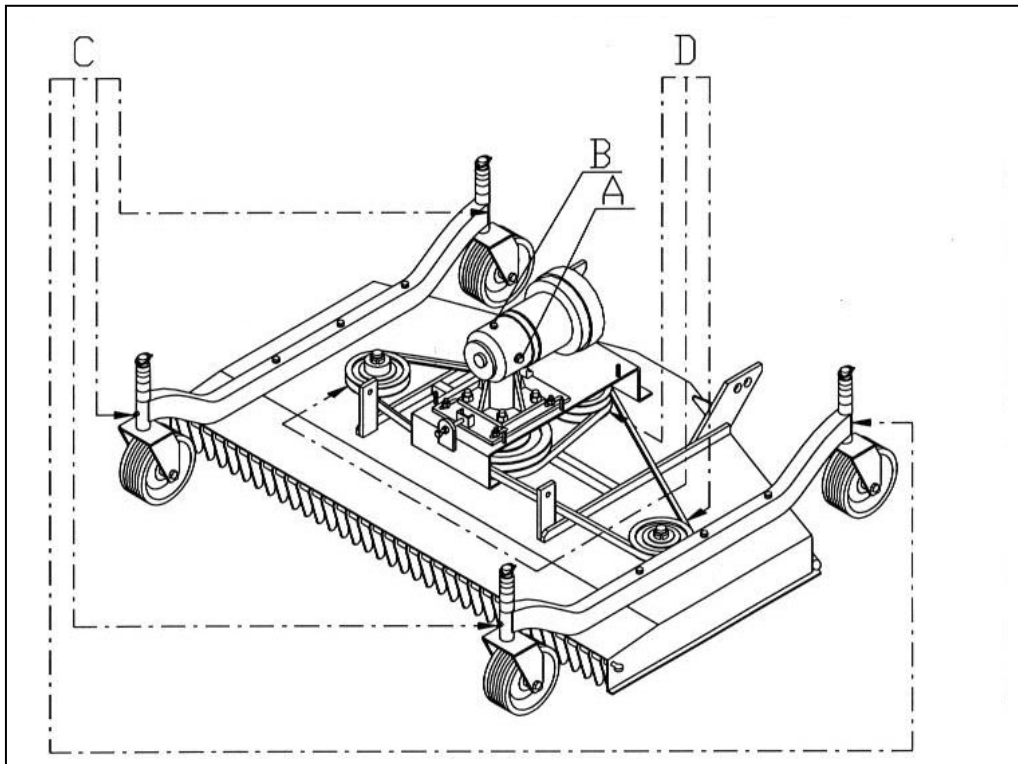

1. With the cutting machine on level, unscrew level plug "A", then check that oil touches on lower hole rim.
2. If level its ok screws the plug "A".
3. If level its low unscrews plug "B" and fill oil.
4. When level its ok screw plugs "A" and "B".

b) To change oil in angular gear box operate as follows :

1. Unscrew plugs "A", "B".
2. Take away oil through hole "B" using a suitable little pump.
3. Put new oil through plug "B".
4. When level its ok screw plugs "A" e "B".

5. BELTS ADJUSTING AND SUBSTITUTION

To adjust the tension or substitute the trapezoidal transmission belts operate as follows :

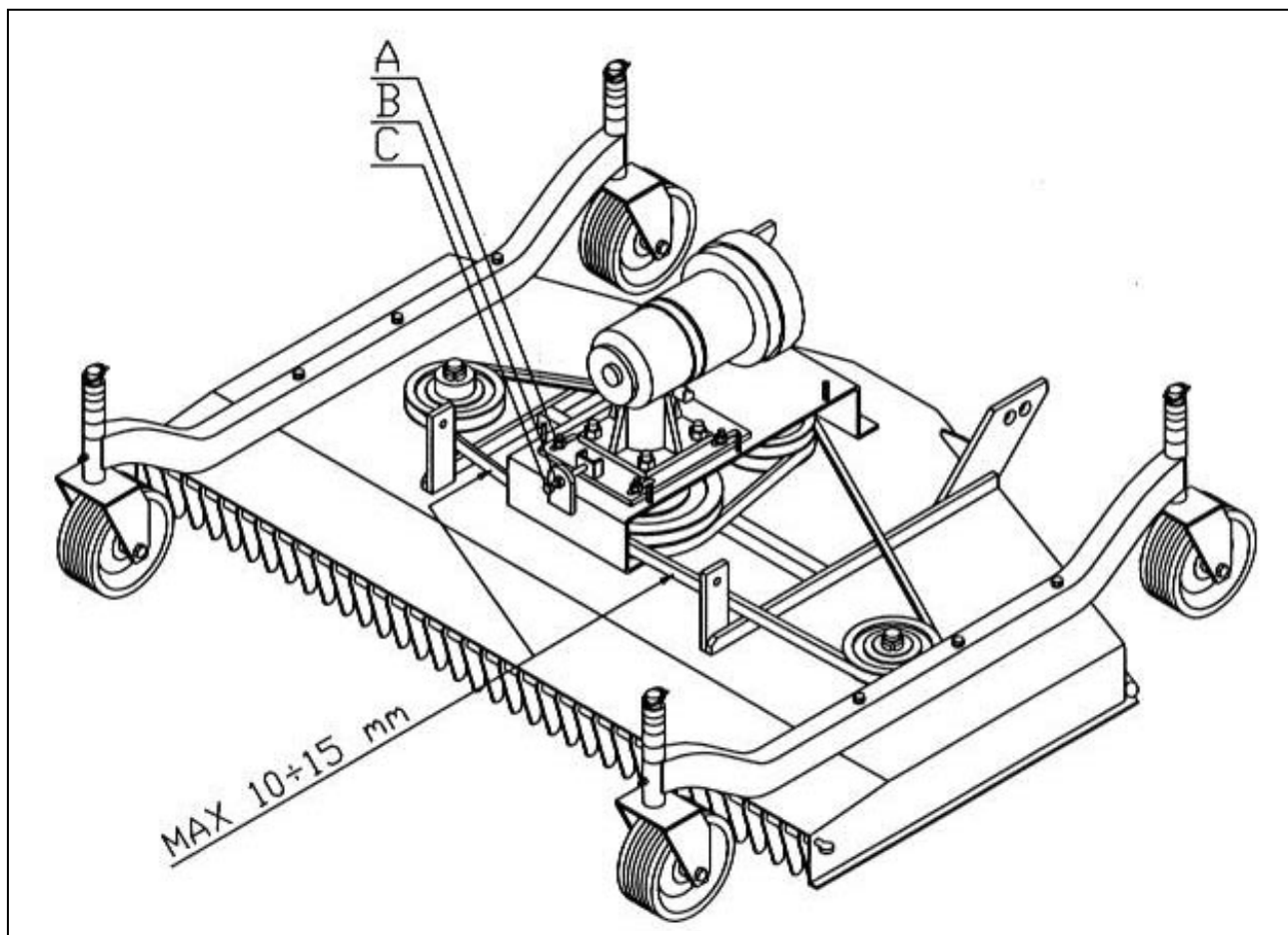

- a) Remove the two upper protection of the cutting component unlocking the fixing screws.
- b) Unlock the 4 screws "A" and nut "B".
- c) To substitute the belts, turn the screw "C" in counter clockwise direction.
- d) Remove the old belt and substitute it with a new one referring to the characteristics in the SPARE PART LIST.
- e) Turn the screw "C" in clockwise direction until to obtain the required tension. The best tension is when pushing with a hand on the belt, this subsides of 10-15 mm, screw nut "B".
- f) To adjust only the tension of the belt, don't read step "d".
- g) Lock the screws "A".
- h) Reassemble the protection.

6. BLADES SUBSTITUTION

To substitute the blades or to make operations of sharpness and/or balance, referring operates as follows:

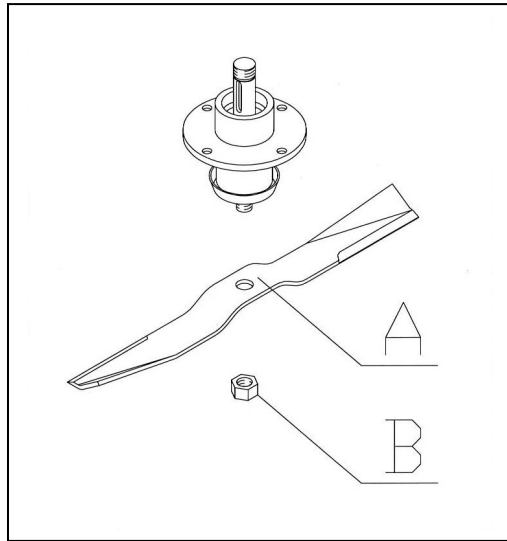

- a) Bring mower in raised position and make sure that the transmission be disconnected.
- b) Take stopped the blade with one hand.
- c) Unscrew the stop ring nut "B".
- d) Remove the blade "A" from its seat and substitute it with a new one or make the operations of sharpness and balance.
- e) Insert the new blade "A" in its seat.
- f) Take stopped the blade with one hand.
- g) Screw the stop ring nut "B" making sure to lock it very much.

PROBLEMS SOLVING

TROUBLES	GROUNDS AND SOLUTIONS
Abnormal vibrations	-Damaged blade - Replace -Broken blade - Replace -Not balanced blade - Balance -Damaged bearings – Change -Damaged hub - Change
Uneven or unsatisfactory cut	-Not sharp blade - Sharp

TRANSPORT

Except when working, moving the machine takes place when the machine is standing still and the transmission is disconnected.

<**Important**>: keep speed low avoiding holes and ground roughness.

<**Important**>: Before begin the movements always make sure that the safety hooks be in position.

<**Note when** on the road, obey existing traffic laws. Exhibit the signal signs on the rear ends. Respect any local laws there may be.

STORAGE

Store the machine in a dry place that isn't dusty.

INFORMATION ON DEMOLITION



At the end of its working life, the machine must be sent to be demolished and that can only be done by an authorized authority, in accordance with the national laws in force for the environment. Therefore it is necessary to get information from the qualified local authorities on the procedure to follow. The machine is mainly composed of: iron materials and paints.

WARRANTY

The machine is covered by the manufacturer warranty for a period of 24 months.

The warranty is not applicable when:

- a) The maintenance work has not been done correctly.
- b) The machine has been used out of its own service.
- c) The machine has been transformed or modified without the manufacturer's written authorization.

GENERAL INDEX

PREFACE	2
DESCRIPTION	3
FUNCTION OF USE	3
PERFORMANCES	3
PERFORMANCES LIMITS	3
STANDARD EQUIPMENT	3
VARIANTS & OPTIONS	3
SAFETY DEVICES	4
TECHNICAL SPECIFICATIONS	4
DRAW-HOOK OF THE TRACTOR	4
CHARACTERISTICS PER MODEL	4
SAFETY INFORMATIONS	5
GENERAL REGULATIONS	5
SAFETY RESTRICTIONS	5
SAFETY SIGNS ON THE MACHINE	6
ASSEMBLING INSTRUCTIONS	7
1. MAIN FRAME "1" ASSEMBLING	10
2. MOUNTING RIGHT CUTTING COMPONENT "8"	11
3. MOUNTING LEFT CUTTING COMPONENT "9"	11
4. MOUNTING REAR CUTTING COMPONENT "7"	11
5. MOUNTING RIGHT CUTTING COMPONENT ON MAIN FRAME	11
6. MOUNTING LEFT CUTTING COMPONENT ON MAIN FRAME	11
7. MOUNTING REAR CUTTING COMPONENT ON MAIN FRAME	12
8. FINAL ASSEMBLING	12
9. GREASING AND LUBRICATION	12
INSRTRUCTION FOR USE	13
1. BEFORE BEGINNING WORK	13
2. TO BEGINNING WORK	14
3. AT THE END OF WORK	14
MAINTENANCE INSTRUCTIONS	15
DIAGRAM "A" SCHEDULED MAINTENANCE	15
1. FRAME GREASING	16
2. FRAME GEAR BOX OIL SUBSTITUTION	16
3. MOWERS GREASING	17
4. MOWERS OIL CECK – OIL SUSTITUTION	17
5. BELTS ADJUSTING AND SUBSTITUTION	18
6. BLADES SUBSTITUTION	19
PROBLEMS SOLVING	20
TRANSPORT	21
STORAGE	21
INFORMATION ON DEMOLITION	21
WARRANTY	21
WORK AND MAINTENANCE SHEET	22