

TUBE•LINE™



PRODUCT CATALOGUE

www.tubeline.ca

Accelerator6
Accumul88
Grabber9
Retriever	10
Technobale	11
Individual Wrappers	
TL1000R	12
TL1100R	14
TL1700SR.	16
TL360	18
Inline Wrappers	
LSV vs ECV	20
TL50	22
TL60	23
TL70	24
Inline Package Options	25
TLR5000	26
Inline Balewrapper Features/Options.	28
Twin Wrap / Laser Guidance System.	30
Film Sensor / Road Flex Suspension.	31
Bale Dispatch	32
Bale BOSS	
Bale BOSS 1	34
Bale BOSS R.	36
Bale BOSS 2	38
Bale BOSS 4	40
BF8000 Balefeeder	42
Nitro Spreaders	
Nitro Spreaders Overview	44
Spinner Deck Beater Assembly	45
Digi-Star Scale Systems	46
Athene System	47
Nitro 275RS	48
Nitro 375RS	49
Nitro 575RS	50
Nitro 725RS	51
Nitro 450	52
Nitro 600	53
Nitro 750	54
Nitro 950	55
Nitro 950TRI.	56
Nitro 1050.	57
Nitro Features	58
Nitro Options.	61
Axle and Wheel Availability	63



R&R means different things to different people. To the employees at Tubeline, R&R means Results & Reliability. It's not just something we say, it's something we engineer, manufacture, and field test. All to ensure that Tubeline produces equipment you can rely on.

Built on the R&R philosophy, all Tubeline products are not only built to handle real life farming, but built with top grade materials to ensure that our products set the standard, and ensuring that you maximize each trip reducing your time in the field. Because at Tubeline we haven't forgotten what R&R means to everyone else.



WARRANTIES

BALEWRAPPER



Inline wrappers carry a 3 Year Limited Warranty. For more information please contact Tubeline Manufacturing.

NITRO



Under the Apron Chain Limited Lifetime Warranty, Tubeline will replace a broken apron chain or connecting link on any Nitro model manure spreader. Restrictions may apply. For more information, please contact the Tubeline office.

ACCELERATOR

HAY CONDITIONER



Specifications	7500T	9500T
Roll Width	7'	9'
Paddles Per Roll	9	9
PTO Speed	540	540
Axle	Tandem	Tandem
Width	132"	156"
Length	153"	153"
Weight (lbs.)	2,900	3,000



Heavy Duty Chain Drive

Transfers power evenly from PTO to both rollers, ensuring constant tension at any roller setting which is achieved by an exclusive pivoting jack shaft.

Adjustable Steel Rollers

Increase or decrease amount of desired crimp by easily adjusting top roller up or down. Solid roller construction ensures consistency of crimping every time.

Walking-Beam Tandem Axle

(Available on 7500T & 9500T)

Provides smoother travel on bumpy fields ensuring consistent pick up of hay.



Spreader (optional)

Evenly distributes hay in wide rows where both sun and wind touch it at once.

ACCUMUL8



NO LONGER DO SMALL BALES MEAN A BIG JOB AHEAD

The Tubeline Accumul8 gives producers time-savings for one of farming's biggest jobs. The Accumul8 is your solution for handling bales efficiently - saving you time and man power. You can now handle eight, ten or twelve bales at one time. This allows one person to quickly gather and load wagons or highway trailers. Keep your farm operating efficiently with the addition of the Tubeline Accumul8.

The Accumul8's mechanical design requires no external hydraulics, PTO or electrical connections. Each bale triggers a series of switches, guiding the next bale into proper location and then releasing the entire pack when full.

Specifications	AC800	AC1000	AC1200*
Bale	8	10	12
Shipping Weight	1,686 lbs.	1,935 lbs.	1,886 lbs.
Dimensions	98"x180"	98"x212"	98"x212"

* Optional kit available for converting to 10 bale

Grabber



Conditioners

Accumulator

Grabbers

For increased efficiency Tubeline's Grabber utilizes large curved tines to pick up bale packs for quick loading into storage and highway trailers. The Grabber is available in a variety of models to compliment Tubeline's Accumul8 series.

Specifications	AC800G	AC1000G	AC1200G
Bale	8	10	12
Shipping Weight	640 lbs.	720 lbs.	800 lbs.
Dimensions	80" x 76"	103" x 78"	115" x 78"

Retriever



The Retriever is a skid steer loader mounted bale accumulator with an integrated 10 bale grapple. The Retriever increases the efficiency of handling small square bales while the reduced handling helps to eliminate leaf loss or broken bales from excess handling.

The Retriever allows one person to quickly gather and load wagons or highway trailers keeping your operation running efficiently.

Specifications	TLG10R
Capacity	10 Bales
Bale Length (min-max)*	34" - 40"
Height	22"
Width	82"
Length	98.75"
Weight	905 lbs.
Hydraulic Cylinder	2-1/2" x 8"
Grapple Hooks	24
Hydraulic Hoses	72"
Mount**	Skid Steer

TECHNOBALE 980

Conditioners

Accumulator

Grabbers

Bale Wagons



TechnoBale 980 carries eight 5 ft. or ten 4 ft. bales on the bed while carrying one additional bale on the loader arm.

Specifications	980
Auxiliary Outlets Required	2
Horsepower Requirement	120 HP min
Tires	15/55 x 17" 18 Ply
Hub Ratings	8 Stud, 12,000 lbs.
Shipping Length	25'
Shipping Width	10'
Operating Width	12'
Shipping Weight	7,200 lbs.
Bale Size	10 (4' x 4' to 4' x 5') 8 (5' x 5' to 5' x 6')
Bale Capacity on Arm	1

TL1000R

INDIVIDUAL BALE WRAPPER



The TL1000R is a valuable addition to any hay producers arsenal. Easy to maintain and even easier to use, the TL1000R uses tractor hydraulics to spin and rotate the bale ensuring it's completely wrapped every time.

To keep 4' and 5' bales centered the TL1000R is equipped with adjustable bale guides. It also features a wrap counter to ensure you get the right amount of wraps on each bale.

Add some value to your operation with a new Individual Balewrapper from Tubeline.

Specifications	TL1000R
Bale Size	4' x 4' & 5' x 6'
Film Width	30" (x2)
Length	104"
Width	80"
Height	84"
Weight	1,600 lbs.
HP Required	30 HP
Three Point Hitch	Category II
Drive Type	Hydraulic
Bale Guides	Adjustable (4' or 5')

TL1000R Features



Wrap Counter

The wrap counter allows you to set the number of wrap rotations for each bale, as well as view the progress for the bale being wrapped.



Offset Twin Wrap Kit

The Twin Wrap Kit offsets the two rolls of wrap creating a 4" leading edge as it wraps the bale.



Bale Rollers

Located on the turntable, the two rollers spin the bale while wrapping, ensuring it's completely sealed.



Transport Lock

The manual transport lock secures the bale platform to prevent dumping during transport.



Bale Guides

Adjustable bale guides allow bales to be centered on the turntable ensuring even delivery of wrap.



Knife

After a bale has been unloaded and a new one is placed on the turntable, the knife easily cuts the plastic wrap for continuous operation.

TL1100R

INDIVIDUAL BALE WRAPPER

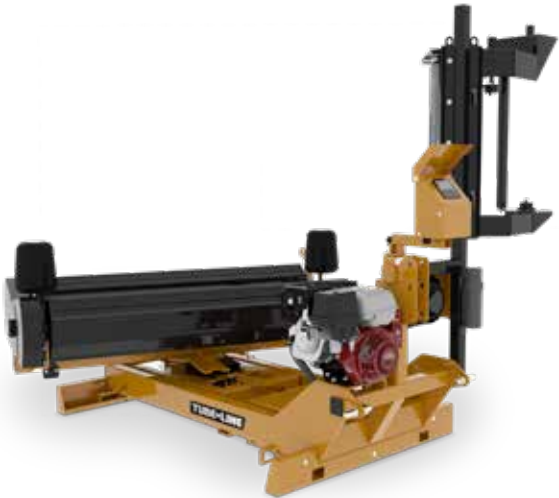

Ideal for small to medium sized operations, the TL1100R is an automatic bale wrapper that takes control of wrapping your round bales individually. Easy to use, this bale wrapper can be run while mounted on the 3PH and connected to the tractors hydraulics or as a standalone unit when equipped with our optional hydraulic power pack.

The TL1100R comes standard with Tubeline's Twin Wrap Kit. The Twin Wrap Kit simultaneously pulls film from two rolls laminating them together to create a stronger film. It also offsets the wrap creating a 4" lead which ensures optimal overlap as the film is layered.

All functions of the TL1100R can be controlled from the wireless remote providing true one person operation.

Specifications	TL1100R
Bale Size (Round)	Up to 5' x 6'
Film Width	30" (x2)
Minimum Hyd. Flow	5 GPM @ 2500 PSI
Hitch	3PH (Category II)
Drive Type	Hydraulic
Bale Guides	Adjustable (4' or 5')
Offset Twin Wrap	Fixed 4"

TL1100R Features

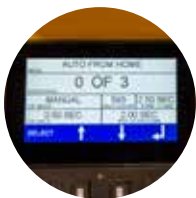

LCD Display

An easy to read display provides real time information and is easy to read in direct sun light.



Wireless Remote

The wireless remote is capable of running all functions of the TL1100R.



Hydraulic Bale Dump

Wrapped bales are hydraulically dumped off the table at the end of the automatic cycle.



Offset Twin Wrap Kit

The offset twin wrap kit provides 4 inches of lead between layers. This increases the number of seams and provides a better seal.



Adjustable Wrap Carrier

Two quick release handles allow the fixed twin wrap carrier to be raised or lowered to properly center the wrap on the bale for even distribution.



Optional Power Pack

The TL1100R-AP model is equipped with the optional power pack for stand alone operation.

TL1700SR

INDIVIDUAL BALE WRAPPER



Hydraulically powered, the TL1700 SR can easily switch between round and square bales by moving the secondary drive shaft on either of the appropriate stub shafts. Each stub shaft changes the drive ratio to provide the appropriate advancement of the bale.

When the carrier arm is placed in the wrapping position, the carrier can be raised or lowered centering the wrap on the bale to provide even plastic coverage throughout the wrapping process.

The TL1700SR is also equipped with Tubeline's Twin Wrap Kit which laminates two layers together to form a stronger 2-ply film of plastic. The Twin Wrap Kit is offset creating a 4" lead which ensures optimal overlap as the film is layered.

Specifications	TL1700SR
Bale Size (Square)	3' x 3' bales from 4' to 7'
Bale Size (Round)	4' x 4' to 5' x 6'
Film Width	30" (x2)
Length	192"
Width	82"
Height	95"
Weight	2,865 lbs.
HP Required	30
Hitch	Trailer (Clevis)
Drive Type	Hydraulic
Guide Roller	2

TL1700SR Features



Wrap Counter

The wrap counter allows you to set the desired number of rotations of wrap per bale and displays the current rotation.



Twin Wrap Kit

The Twin Wrap Kit offsets the two rolls of wrap creating a 4" leading edge as it wraps the bale.



Power Pack

An optional power pack allows you to run the TL1700SR without the need for the hydraulics on a second tractor.



Bale Mat

An integrated bale mat protects your wrapped bales from puncture as they are unloaded.



Square to Round Adjustment

Adapting the TL1700SR to work with square or round bales is as easy as attaching the secondary drive shaft to the appropriate stub shaft.



Film Carrier Adjustment

To ensure full coverage of the bale the wrap carrier is adjustable to ensure it is centered across the middle of the bale.

Fully Automatic Cycling

Convert your TL 1700SR Bale Wrapper to fully automatic cycling with our Automatic Wrapping Option. Featuring an easy to use console for wrapper initializing and setup, you can also remote start and stop from the tractor's seat.



TL360



Expanding on our line of individual bale wrappers the TL360 brings high speed in the field wrapping to round bale producers.

The self-loading design allows you wrap on the go while following the baler. The loading arm allows operators to carry a second bale while one is being wrapped.

A cut and hold system ensures that the film is always ready for the next bale while an optional bale tipper lays the bale on its side for easy handling with a grapple.

TL360 Options

- Twin Wrap Kit
- LED Working Lights
- Bale Tipper
- Remote Control Kit for Stationary Wrapping



TL360 Features



Control Panel

An intuitive control panel is mounted to the TL360 for easy control when you're not in the tractor.



Tongue Lock

A tongue lock secures the tongue while the wrapper is in the transport or wrapping position.



Cut and Hold

The cut and hold system ensures that the plastic is secured and ready for new bale that enters the wrapper.

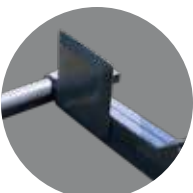

Bale Guides

Adjustable bale guides on the loading arm and wrapping chamber allow the TL360 to accommodate 4' or 5' bales.

Specifications	TL360
Unit Type	Trailed, Self Loading
Height	133"
Width	119"
Length	164"
Weight	5,100 lbs.
Bale Sizes	4' x 5.5' diameter 5' x 4.5' diameter
Tractor HP	60HP
Hydraulic Requirement	16 GPM
Hitch Type	Clevis

LSV Series



The LSV series of BaleWrappers feature our standard electric over hydraulic controls. LSV series controls combine analogue switches and hydraulic levers.



The LSV control panel comes standard with a lifetime bale counter.



Optional equipment can be controlled through the use of toggle switches located on the bottom of the control panel.



Hydraulic levers control the table and optional power drive systems.

ECV Series

Conditioners

Accumulator

Grabbers

Bale Wagons

Wrappers



ECV Series BaleWrappers combine our reliable electric over hydraulic controls with an easy to use digital console which provides the brains behind our precision wrapping.

The digital control panel allows you to select functions, and configure settings at the touch of a button.



The multi-function joystick provides centralized control over steering and our optional power drive.



Large rocker switches are provided for primary features like Power, Emergency Stop, and optional features like Remote Engine Start and Night Lights.



- Soft Start
- Bale Counter (Lifetime)
- Bale Counter (Resettable)
- Bale Presets
- Large Easy to Read Display
- Remote Engine Start
- Self-Diagnostics
- Single Joystick Control to drive/steer

TL50



Specifications	TL 50
Overall Length	18'
Width	9' 5"
Height	9' 10"
Weight	6,300 lbs.
Power	13 HP Honda c/w 11 GPM Pump
Electric Start	Standard
Alternator	18 Amp.
Hydraulics	Self-contained
Controls	Electric over Hydraulic (LSV) Electronic Control Valve (ECV)
Tires	(2) 11L x 15 8 Ply (2) 27 x 10.5 Traction
Quick Start Leveling	Quick Deck Adjust
Compaction	Deck Tight Pack
Steering	Hydraulic
Emergency Stop	E Stop Button
Roll Off Tail	Fixed
Transport Lights	Standard
Bale	
Round	Up to 6'
Square	N/A
Film Stretcher	(2) 30" x 55%
Bale Saddles	-
Bale Guide Rollers	Standard (x2)
Hoop Speed	Man. (LSV) / Elec. (ECV)
Shipping Dimensions	
Length	19'
Width (Without Guards)	8' 6"
Height	9'



TL 60



Specifications	TL 60
Overall Length	20'
Width	9' 5"
Height	9' 10"
Weight	7,600 lbs.
Power	13 HP Honda c/w 11 GPM Pump
Electric Start	Standard
Alternator	18 Amp.
Hydraulics	Self-contained
Controls	Electric over Hydraulic (LSV) Electronic Control Valve (ESV)
Tires	(2) 11L x 15 8 Ply (2) 27 x 10.5 Traction
Quick Start Leveling	Quick Deck Adjust
Compaction	Deck Tight Pack
Steering	Hydraulic
Emergency Stop	E Stop Button
Roll Off Tail	Fixed
Transport Lights	Standard
Bale	
Round	Up to 6'
Square	Up to 3' x 3' x 6' & 4' x 4' x 6'
Film Stretcher	(2) 30" x 55%
Bale Saddles	Adjustable
Bale Guide Rollers	Standard (x4)
Hoop Speed	Man. (LSV) / Elec. (ECV)
Shipping Dimensions	
Length	19' 8"
Width (Without Guards)	8' 6"
Height	9' 5"



TL 70



Specifications	TL 70
Overall Length	25' 6"
Width	10' 8"
Height	10' 7"
Weight	9,600 lbs.
Power	20 HP Honda c/w 16 GPM Pump w/ Hyd. Cooler
Electric Start	Standard
Charging System	18 Amp.
Hydraulics	Self-contained
Controls	Electric over Hydraulic (LSV) Electronic Control Valve (ESV)
Tires	(4) 12.5 x 15 Highway Service
Quick Start Leveling	Quick Deck Adjust
Compaction	Adj. Cam Action/Deck Tight Pack
Steering	Hydraulic
Emergency Stop	E Stop Button
Offset Twin Wrap	Standard
Roll Off Tail	Hydraulic Lift
Transport Lights	Standard
Bale	
Round	Up to 6'
Square	Up to 4' x 4' x 6' Up to 3' x 3' x 7'
Square (Double Stacked)	3' x 3' x 5' 6" - 3' x 4' x 5' 6"
Film Stretcher	(2) 30" x 55%
Bale Saddles	Adjustable
Bale Guide Rollers	Optional
Hoop Speed	Adj. Flow Control Valve
Shipping Dimensions	
Length	17'
Width (Without Guards)	10'6"
Height	10'7"



TL Series Package Options

Not Available on TLR5000 models

SILVER

TL50 & TL60 Only

- Wireless Plastic Sensor Shutdown Kit
- Remote Steer / Shut Down (includes Remote Start)
- LED Work Lights
- Bale Dispatch (side mounted arm)
- Includes Silver Package Badging

GOLD

- Wireless Plastic Sensor Shutdown Kit
- Remote Steer / Shut Down (includes Remote Start)
- LED Work Lights
- Bale Dispatch (side mounted arm)
- **20HP Engine**
- **Includes Gold Package Badging**

PLATINUM

- Wireless Plastic Sensor Shutdown Kit
- Remote Steer / Shut Down (includes Remote Start)
- LED Work Lights
- Bale Dispatch (side mounted arm)
- 20HP Engine
- **Offset Twin Wrap Kit**
- **Dual Power Drive**
- **Laser Guidance System**
- **Includes Platinum Package Badging**

TLR5000



Specifications	TLR 5000
Overall Length	18'
Width	9'
Height	9'
Weight	5,100 lbs.
Power	13 HP Honda c/w 11 GPM Pump
Electric Start	Standard
Alternator	18 Amp.
Hydraulics	Self-contained
Controls	Electric over Hydraulic (AX2) Electronic Control Valve (ECV)
Tires	(2) 11L x 15 8 Ply (2) 27 x 10.5 Traction
Quick Start Leveling	Quick Deck Adjust
Brakes (Compactor)	Deck Tight Pack
Steering	Hydraulic
Emergency Stop	E Stop Button
Roll Off Tail	Fixed
Transport Lights	Standard
Bale	
Round	Up to 6'
Square	N/A
Film Stretcher	(2) 30" x 55%
Bale Saddles	Fixed
Bale Guide Rollers	Standard
Hoop Speed	Adj. Flow Control Valve
Shipping Dimensions	
Length	19'
Width (Without Guards)	8' 6"
Height	9'





TLR5000 AX2 Shown with Options

Standard Features (Differences shown)	TL 50 (LSV / ECV)	TL 60 (LSV / ECV)	TL 70 (LSV / ECV)
13HP Honda Engine	Std.	Std.	-
20HP Honda Engine with High Flow Pump	Opt.	Opt.	Std.
Round to Square Bale Wrapper Conversion	-	Std.	Std.
Roller Bed Locking Lever	-	-	Std.
Larger Hoop for 6' Round Bales	Std.	Std.	Std.
Soft Start	- / Std.	- / Std.	- / Std.
30" Pre-Tensioners	Std.	Std.	Std.
Large Easy to Read Display	- / Std.	- / Std.	- / Std.
Bale Counter (Lifetime)	Std. / Std.	Std. / Std.	Std. / Std.
Bale Counter (Resettable)	- / Std.	- / Std.	- / Std.
Bale Presets	- / Std.	- / Std.	- / Std.
Remote Engine Start	Opt. / Std.	Opt. / Std.	Opt. / Std.
Self-Diagnostics	- / Std.	- / Std.	- / Std.
Single Joystick Control to Steer/Drive (with opt. Power Drive)	- / Std.	- / Std.	- / Std.

Options			
Single Hydraulic Power Drive	Opt.	Opt.	-
Guide Rollers on Discharge Ramp	Std. (x2) Opt. (x2)	Std. (x4)	Std. (x2) Opt. (x2)
Spring Assist Final Bale Push Off Arm	Opt.	Opt.	Std.
Twin Wrap Kit	Opt.	Opt.	Std.
Road Flex Suspension	Opt.	Opt.	Opt.
20HP Honda Engine Kit c/w High Flow Pump	Opt.	Opt.	Std. (16 GPM)

*Twin Wrap Kit standard

Standard Features (Differences shown)

**TLR5000
(AX2 / ECV)**

13HP Honda Engine	Std.
20HP Honda Engine with High Flow Pump	Opt.
Round to Square Bale Wrapper Conversion	-
Roller Bed Locking Lever	-
Larger Hoop for 6' Round Bales	Std.
Soft Start	- / Std.
30" Pre-Tensioners	Std.
Large Easy to Read Display	- / Std.
Bale Counter (Lifetime)	- / Std.
Bale Counter (Resettable)	- / Std.
Bale Presets	- / Std.
Remote Engine Start	Opt. / Std.
Self-Diagnostics	- / Std.
Single Joystick Control to Steer/Drive (with opt. Power Drive)	- / Std.

Options

Single Hydraulic Power Drive	Opt.
Guide Rollers on Discharge Ramp	Std. (x2)
Spring Assist Final Bale Push Off Arm	Opt.
Twin Wrap Kit	Opt.
Road Flex Suspension	-
20HP Honda Engine Kit c/w High Flow Pump	Opt.



Conditioners

Accumulator

Grabbers

Bale Wagons

Wrappers

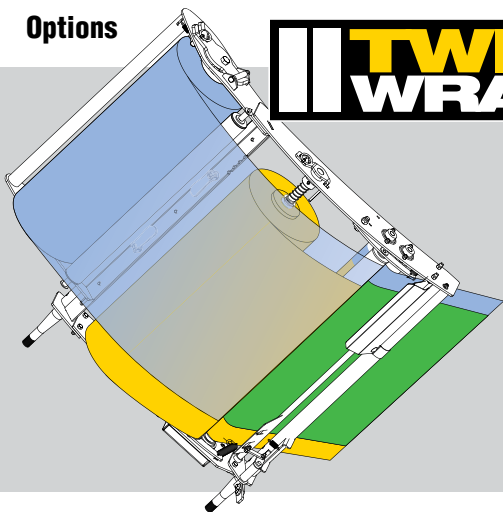
Options**TWIN
WRAP****Offset Twin Wrap Kit***Optional on TL Series*

The Twin Wrap Kit holds two rolls of film and passes them through a single stretcher. This activates the wraps' bonding compound to form a strong 2-Ply layer of film that stands up to tough hay stalks and folds them over, helping to prevent piercing of the wrap. The adjustable offset allows the leading edge of the wrap to be extended up to 4" providing increased overlap of plastic layers.

**LASER
GUIDANCE SYSTEM****Automatic Steering System***Optional on all models.*

Tubeline's new laser guided steering system makes small incremental adjustments to keep the wrapper tracking along the desired path. The laser constantly takes measurements and automatically makes steering adjustments to maintain the programmed distance from another bale tube, fence line or even dense crops.

FILM SENSOR TX

Options



Optional

Using wireless technology, Tubeline's Film Sensor TX can detect when your wrap breaks or runs out and automatically sends a shut-down signal to the machine. This ensures your bales don't go through the hoop without proper coverage.

ROAD FLEX S U S P E N S I O N



Optional

The TL50 and TL60 models can also be outfitted with the Road Flex suspension system. This not only reduces towing stress, but absorbs shock when heavy silage bales are placed onto the balewrapper giving your balewrapper a longer life.

DISPATCH

123

Finish off your rows in seconds with Tubeline's Dispatch final bale pushoff system.

Tubeline's final bale push off system allows operators to push off the final bale with as little as two cycles of the wrapper.

Step 1.

Use the standard push ram to push the final bale through the hoop.

Step 2.

Cut the wrap using Tubeline's exclusive Film Snap system.

Step 3.

Unload the bale tube using the standard crosstube or optional side mounted spring assisted fold down arm.

PUSH RAM



Push Off in Seconds With Ease

Standard on all models.

The Push Ram travels a short distance providing quicker cycle times. This translates to less time finishing your bale row and more time wrapping.



Cut Your Wrap in a Snap!

Standard on all AX2 and ECV series models.

Standard on all inline Balewrapper models, Tubeline's Film Snap option easily cuts wrap with the press of a button. Press and hold the Film Snap button located beside the operator's panel until both tensioners pass, triggering each Film Snap bar. The Film Snap bar cuts the wrap quickly and easily without stopping the wrapper, allowing you to finish your row faster.



Optional Spring Assist Final Bale Pushoff

Available on select models.

Optional on select models, the Bale Dispatch makes final bale push off even easier. Mounted to the side of the wrapper the spring assisted Bale Dispatch lowers across the tail to form a solid push bar. Once deployed one cycle of the ram is enough to push the bale from the tail of the wrapper.

BALEBOSS 1

SQUARE BALE PROCESSOR



Just Scoop N' Go.

The BOSS 1 is a square bale processor that mounts on your skidsteer, tractor loader, or telehandler combining adaptability with accessibility. The BOSS 1 allows you to bed in tight spots that are nearly impossible to get to with a trail behind processor.

The unique loader-mount design allows you to raise the BOSS 1 above gates and pens providing greater control of where the processed bale ends up. The versatility of a loader mounted unit makes operating it easier and more comfortable. Because the BOSS 1 is upfront, loading bales is quick and simply just Scoop N' Go.

The 20 Series provides better material management allowing tougher materials to flow through effortlessly whether you're windrowing, bunk feeding or livestock bedding. Utilizing features such as the removable folding floor and retainer bars, you can rest easy knowing the BOSS 1 20 series has you covered.



* For optimal spreading performance high flow is recommended

Specifications	BOSS 3720HF	BOSS 3820HF	BOSS 4920
Min Hyd. Flow GPM / P.S.I. ***	18-25 / 2500 P.S.I.	18-25 / 2500 P.S.I.	20-40 / 3000 P.S.I.
High Flow Motor	Opt.	Opt.	NA
Weight	1,590 lbs.	1,640 lbs.	3,300 lbs.
Width	110"	122"	146.5"
Length	52"	52"	74.75"
Height (std.) Top Beater Kit (opt.)	53" 63"	53" 63"	68" NA
Bale Capacity	1	1	1
Bale Sizes	36" x 36" x 84"	36" x 36" x 96"	48" x 48" x 96"
Bale Material	Straw/Hay	Straw/Hay	Straw/Hay
Mount	Universal Skisteer / Quick Attach (opt.)		Quick Attach

*** Over 25 G.P.M requires case drain to be hooked up



Restrictor Bars

Adjustable restrictor bars keep loose bales from flaking into the shredding chamber ensuring consistent performance.



Knives

Serrated knives further process material as it passes through.



Drop Floor

The adjustable drop floor design provides optimal pass through of materials such as hay.



Top Beater Kit (optional)

The top beater kit assists in the processing of 3 x 4 bales by helping to push the top of the bale down towards the shredding chamber.

BALEBOSS R

ROUND BALE PROCESSOR



The Bale Boss R is built with the same versatility and quality you've come to expect from the Bale Boss family. Bale Boss R holds one round bale up to 4 feet wide and up to 6 feet in diameter.

Easy to use, the self loading arm easily picks up round bales placing them onto the apron chain. Equipped with spikes, the apron chain easily grabs onto the bale turning it against the restrictor bars as the flail rotor pulls apart the bale.

All of the controls for the Bale Boss R are accessible on the wired controller and features a variable speed rate to provide the right amount of throw and processing.

Specifications	Bale BOSS 1
Min Hyd. Flow (GPM/P.S.I.)	18 / 2500 P.S.I.
Weight	1,900 lbs.
Width	85"
Length	74"
Height	76"

Round Bale Sizes

Up to 4 ft wide
Up to 6 ft diameter



Bale BOSS R Features



Loader Mount

The Bale Boss R easily mounts to front loaders.



Controller

All of the Bale Boss R functions are accessible through the wired controller.



Self Loading

A hydraulic loading arm easily loads hay bales into the processing chamber.



Apron Chain

A rugged apron chain feeds the bales into the flail for processing.



Flail Rotor

Consistent processing performance comes from the flail rotor assembly and the restrictor bars.



Deflector

An adjustable deflector helps control direction of the straw as it leaves the machine.

BALE BOSS 2

SQUARE BALE PROCESSOR



Boss 2 model shown

LEAVE IT TO THE BOSS.

The Bale BOSS 2 is the perfect tool for all of your large square bale processing needs. From bedding to feeding, the Boss 2 can manage it all.

The BOSS 2 is fully adjustable to fit 3'x3', 3'x4' and 4'x4' square bales, up to 9' long monsters. The adjustable distribution chute allows the same machine to bed livestock with bales of straw, then feed into bunkers or windrows with only a quick adjustment. The adjustments don't stop there. The BOSS 2 can also be equipped with optional cutting knives that help to further process bedding material for a finer and more consistent spread.

The hydraulic feed is also adjustable, allowing you to control the flow and speed of feeding. The flail roller is PTO-driven and adaptable to either 540 or 1000 RPM, while the upper paddle roller is hydraulically controlled and also fully adjustable. The hydraulic self-loading forks allow you to load one bale and have another standing by ready to go.

The Bale BOSS 2 can be customized with an optional narrow wheel track making it ideal for spreading straw over delicate berry fields. This option also includes suitcase weights to balance the unit.



Boss 2 HD model shown with optional WHE15LT tire package.

Specifications	BOSS 2	BOSS 2 HD
HP Required	80-180	120-250 HP
Tires	12.5L x 15	12.5L x 15
Weight	4,170 lbs.	5,150 lbs.
Dimensions (LWH)	126" x 140" x 90"	126" x 144" x 94"
Bale Capacity	2	2
PTO	540 or 1,000 RPM	540 or 1,000 RPM
Drive Belt	37 mm	87 mm
Number of Flails	38	38
Top Paddle Roller	Yes	NA
Deflector	Man / Hyd (opt.)	Hyd
Round Bale sizes	36" x 36" x 96"	36" x 36" x 96"
	48" x 36" x 96"	48" x 36" x 96"
	48" x 48" x 96"	48" x 48" x 96"



Boss 2 Shown with Narrow Track Width Option

BALEBOSS 4

SQUARE BALE PROCESSOR



Providing increased capacity the Bale BOSS 4 can carry up to four 4'x4'x9' bales. The bales are easily loaded with the hydraulic self loading deck. Raise the deck to spear your stack then lower it back into position. Equipped with dual apron chains the hydraulically driven drive system simultaneously powers two apron chains, ensuring that the bales glide across the deck and into the awaiting processor.





Specifications

Bale BOSS 4

Overall Length	28'
Overall Width	12.5'
Bale Bed Length	17'
Bale Bed Width	8'
Shipping Weight	11,000 lbs.
Bale Bed Picks Up	4 - 4' x 4' bales
Shredder Deck Accepts (removed for shipping)	3' x 3' x 9' 4' x 3' x 9' 4' x 4' x 9'
Tires	Tandem Lug Tires 12.4x24x8
Adjustable Tongue Height	Yes
HP Rating	120-250 HP



BF8000



The BF8000SL is designed to feed out round bales up to 6' in diameter and weighing up to 2,500 lbs. The BF8000SL is equipped with a hydraulic loading arm and two prong bale spear, to lift and place the bale on the table. The loading arm can also be used to carry a second bale to the field. Once placed on the table, an apron chain rotates the bale as the drum's fingers unravel the hay. As the core of the bale is approached, the table can be tilted increasing contact between the bale and the drum ensuring the entire bale is fed out.

Specifications

BF8000SL

Unit Type	Trailed, Self Loading
Height	66"
Width	119"
Length	221"
Weight	3,700 lbs.
For use with	Hay, Straw, Baleage, Silage
Bale Size	4-5' Wide up to 6' Round
Bale Weight	2,500 lbs. Maximum



BF8000 Features



Self Loading

The BF8000SL has a hydraulic self loading design removing any need for additional equipment to load bales onto the BaleFeeder table.



Bale Spear Position Indicator

The mechanical loading arm position indicator lets you know when the bale spears are in the ideal position for loading different sizes of bales, or when the loading arm is in position for transporting.



Live Floor with Apron Chain

The live floor has steel slats, driven by two robust apron chains, driving the bale towards the rotor with ease.



Table Angles up to 22.5°

The live floor hydraulically angles up to 22.5° ensuring the last of each bale gets placed onto the field where you want it.



Retractable Fingers

The BaleFeeder's drum uses retractable fingers to grab and fluff the bale on the table side, while retracting back into the drum on the unloading side preventing material from being pulled back under the drum back onto the table.

BF8000 Options

- Storage Box
- Implement Tires
- Square Bale Extension
- Tractor Lug Tires



NITRO

NITRO RS - STANDARD FEATURES

- Guillotine end gate
- Front stone guard
- Steel sidewall
- Poly board floor
- Robust heavy duty logging style apron chain with a LIMITED LIFETIME WARRANTY
- Removable/replaceable apron slats
- Hydraulic drive on apron chain to accurately adjust feed speed
- Quick removable beaters for windrowing, etc.

NITRO - STANDARD FEATURES

- Same standard features as Nitro RS
- Poly board sidewall
- Side mounted access ladder
- Suspension tongue *(Standard on 950 only)*



Each Nitro apron chain carries a limited lifetime warranty, under which Tubeline will replace a broken apron chain or connecting link.



Spinner Deck Beater Assembly Option

Nitro spreaders can be equipped with an optional Spinner Deck beater assembly. The interchangeable quick-drop beater system allows operators to conveniently switch between the vertical or spinner deck assemblies offering flexibility to both producers and custom operators.

Designed to maximize distribution while metering the flow of material, the Spinner Deck beater assembly utilizes a complete gear box drive system that drives both the horizontal beaters and spinners together to ensure consistent unloading.



Drop-On Adjustment

The lower portion of the door is adjustable allowing material to drop across more of the spinner for better distribution of material.



Dual Horizontal Beater Assembly

The Nitro Spinner Deck beater assembly comes equipped with two horizontal beaters to ensure a consistent amount of material is fed to the spinners.



Dual Spinners

High speed spinners hold material accelerating it to maximize the spread. The lower portion of the apron is adjustable allowing material to drop across more of the spinner for better distribution of material.



Spread Limiter

The hydraulically powered spread limiter can be raised and lowered to prevent material from being spread onto any unwanted surface, including roadways and yards.

Optional Scale Systems

Digi-Star ★

Digi-Star® Scale Systems

Optional on all models.



The optional Digi-Star® 5pt 60,000 lb. differential weigh beam system is available on all Nitro models. Four of the load cells are located under the box and the fifth cell is placed on the hitch.



GT 400

Accounting for environmental protection, the Digi-Star® scale system lets you know how many tons you've hauled and spread on your fields, perfect for both farmers and custom operators.



NT 560 with AutoLog™



Actual screen display from Athene System shown

Athene System Variable Rate Manure Spreader Control System

ISOBUS UT displays spreader controls and variable rate (if available on terminal)

Athene/SL2 controls spreader and scale system

- Proportional to forward speed control - ensures application rate is correct irrespective of changes in the forward speed
- Variable rate capability - allows manual or automatic adjustment of application rates indifferent field areas to suit conditions
- ISOBUS TC GEO compliant - allows automatic adjustment of application rates in different field areas according to a pre-defined treatment map
- ISOBUS TC sectional control compliant - simplifies operation by turning spreader on/off automatically to avoid overlaps and misses

NITRO 275RS



Specifications

Nitro 275RS

Carrying Capacity	10 Ton
Heaped (cu. ft.)	294
Struck Level (cu. ft.)	201
Inside Dimensions (Inside width between flare 89")	62.5"W x 34.5"D x 143"L
Overall Length	23.5'
Overall Outside Width (Single Axle)	118"
Overall Outside Width (Tandem Axle)	115.5"
Loading Height (Single Axle)	69"
Loading Height (Tandem Axle)	69"
Wheel Hub Capacity (Tandem Axle)	12,000 lbs. (8-bolt) x4
Tandem Tire Sizes	425/22.5 Recap Truck or 550/45-22.5 Flotation
Wheel Hub Capacity (Single Axle)	16,000lbs (10-bolt) x2
Single Tire Sizes	425/22.5 Recap Truck or 550/45-22.5 Flotation or 480/70-30 Tractor Lug Tire
Beater Diameter	34"
Beater Speed	420 RPM
PTO Speed	1000 RPM
Apron Chain Link Dia.	5/8"
Shipping Weight	8,800 lbs. / 3,992 kg.
Required Tractor PTO HP	80
Brakes Available	Yes

NITRO 375RS



Specifications	Nitro 375RS
Carrying Capacity	13 Ton
Heaped (cu. ft.)	444
Struck Level (cu. ft.)	266
Inside Dimensions (Inside width between flare 89")	62.5"W x 34.5"D x 175"L
Overall Length	25'
Overall Outside Width (Single Axle)	126"
Overall Outside Width (Tandem Axle)	115"
Loading Height (Single Axle)	76"
Loading Height (Tandem Axle)	75"
Wheel Hub Capacity (Tandem Axle)	12,000 lbs. (8-bolt) x4
Tandem Tire Sizes	425/22.5 Recap Truck 550/45-22.5 Flotation
Wheel Hub Capacity (Single Axle)	16,000lbs (10 bolt) x2
Single Tire Sizes	600/65-34
Beater Diameter	34"
Beater Speed	420 RPM
PTO Speed	1000 RPM
Apron Chain Link Dia.	5/8"
Shipping Weight	9,139 lbs. / 4,145 kg.
Required Tractor PTO HP	90
Brakes Available	Yes

Conditioners

Accumulator

Grabbers

Bale Wagons

Wrappers

Processors

Spreaders

NITRO 575RS



Specifications

Nitro 575RS

Carrying Capacity	16 Ton
Heaped (cu. ft.)	576
Struck Level (cu. ft.)	379
Inside Dimensions (Inside W btwn. flare 102 & 89" respectively)	62.5"W x 45.5"D x 218"L
Overall Length	27.5'
Overall Outside Width (Single Axle)	131"
Overall Outside Width (Tandem Axle)	116"
Loading Height (Single Axle)	88.5"
Loading Height (Tandem Axle)	80"
Wheel Hub Capacity (Tandem Axle)	12,000 lbs. (8-bolt) x4 16,000 lbs. (10-bolt) x4
Tandem Tire Sizes	425/22.5 Recap Truck 550/45-22.5 Flotation 700/50-26.5 Flotation
Wheel Hub Capacity (Single Axle)	20,000lbs (10-bolt) x4
Single Tire Sizes	710/70 R38 Tractor Lug
Beater Diameter	34"
Beater Speed	420 RPM
PTO Speed	1000RPM
Apron Chain Link Dia.	5/8"
Shipping Weight	11,000 lbs. / 4,990 kg.
Required Tractor PTO HP	125
Brakes Available	Yes

NITRO 725RS



Specifications	Nitro 725RS
Carrying Capacity	19 Ton
Heaped (cu. ft.)	767
Struck Level (cu. ft.)	507
Inside Dimensions (Inside W btwn. flare 102 & 89" respectively)	71"W x 50"D x 240"L
Overall Length	30.3'
Overall Outside Width (Single Axle)	136"
Overall Outside Width (Tandem Axle)	136"
Loading Height (Single Axle)	93"
Loading Height (Tandem Axle)	93"
Wheel Hub Capacity (Tandem Axle)	16,000 lbs. (10-bolt) x4
Tandem Tire Sizes	700/50-26.5 Flotation Tires
Wheel Hub Capacity (Single Axle)	20,000 (10 bolt) x2
Single Tire Sizes	710/70 R42 Tractor
Beater Diameter	36"
Beater Speed	420 RPM
PTO Speed	1000RPM
Apron Chain Link Dia.	5/8"
Shipping Weight	15,652 lbs. / 7,099 kg.
Required Tractor PTO HP	165+
Brakes Available	Yes

Conditioners

Accumulator

Grabbers

Bale Wagons

Wrappers

Processors

Spreaders

NITRO 450



Specifications

Nitro 450

Carrying Capacity	13 Ton
Heaped (cu. ft.)	481
Struck Level (cu. ft.)	290
Inside Dimensions (Inside width between flare 102.5")	62"W x 40"D x 201"L
Overall Length	27'
Overall Outside Width (Single Axle)	115"
Overall Outside Width (Tandem Axle)	116"
Loading Height (Single Axle)	77"
Loading Height (Tandem Axle)	79" (550/45-22.5) 77" (425/22.5 recap)
Wheel Hub Capacity (Tandem Axle)	12,000 lbs. (8 bolt) x4
Tandem Tire Sizes	550/45-22.5 or 425/22.5 recap truck
Wheel Hub Capacity (Single Axle)	16,000lbs (10 bolt) x2
Single Tire Sizes	600/65-34
Beater Diameter	34"
Beater Speed	420 RPM
PTO Speed	1000 RPM
Apron Chain Link Dia.	5/8"
Shipping Weight	11,355 lbs. / 5,150 kg.
Required Tractor PTO HP	125+
Brakes Available	Yes

NITRO 600



Specifications

Nitro 600

Carrying Capacity	17 Ton
Heaped (cu. ft.)	636
Struck Level (cu. ft.)	406
Inside Dimensions (Inside width between flare 102.5")	62"W x 50"D x 227"L
Overall Length	29.5'
Overall Outside Width (Single Axle)	131"
Overall Outside Width (Tandem Axle)	131"
Loading Height (Single Axle)	90"
Loading Height (Tandem Axle)	85" (550/45-22.5) 92" (700/50-26.5) 87" (425/22.5 recap)
Wheel Hub Capacity (Tandem Axle)	16,000 lbs. (10 bolt) x4
Tandem Tire Sizes	550/45-22.5, 700/50-26.5 or 425/22.5 recap
Wheel Hub Capacity (Single Axle)	20,000lbs (10 bolt) x2
Single Tire Sizes	710/70-38
Beater Diameter	34"
Beater Speed	420 RPM
PTO Speed	1000 RPM
Apron Chain Link Dia.	5/8"
Shipping Weight	13,930 lbs. / 6,319 kg.
Required Tractor PTO HP	150+
Brakes Available	Yes

NITRO 750



Specifications	Nitro 750
Carrying Capacity	20 Ton
Heaped (cu. ft.) (with Optional Silage Extension)	838 1,038
Struck Level (cu. ft.) (with Optional Silage Extension)	560 770
Inside Dimensions (Inside width between flare 102.5")	67"W x 58"D x 252"L
Overall Length	32.5'
Overall Outside Width (Single Axle)	136"
Overall Outside Width (Tandem Axle)	136"
Loading Height (Single Axle) (with Optional Silage Extension)	100" 116"
Loading Height (Tandem Axle) (with Optional Silage Extension)	102" 118"
Wheel Hub Capacity (Tandem Axle)	16,000 lbs. (10 bolt) x4
Tandem Tire Sizes	700/50-26.5
Wheel Hub Capacity (Single Axle)	20,000lbs (10 bolt) x2
Single Tire Sizes	710/70-42
Beater Diameter	36"
Beater Speed	420 RPM
PTO Speed	1000 RPM
Apron Chain Link Dia.	5/8"
Shipping Weight	16,195 lbs. / 7,346 kg.
Required Tractor PTO HP	180+
Brakes Available	Yes

NITRO 950



Specifications

Nitro 950

Carrying Capacity	25 Ton
Heaped (cu. ft.)	1,028
(with Optional Silage Extension)	1,252
Struck Level (cu. ft.)	695
(with Optional Silage Extension)	918
Inside Dimensions	67"W x 58"D x 297"L
(Inside width between flare 102.5")	
Overall Length	35.25'
Overall Outside Width (Single Axle)	N/A
Overall Outside Width (Tandem Axle)	136"
Loading Height (Single Axle)	N/A
(with Optional Silage Extension)	N/A
Loading Height (Tandem Axle)	109"
(with Optional Silage Extension)	125"
Wheel Hub Capacity (Tandem Axle)	20,000 lbs. (10 bolt) x4
Tandem Tire Sizes	750/60-30.5 Floatation or 750/60-30.5 Floatation (Radial)
Wheel Hub Capacity (Single Axle)	N/A
Single Tire Sizes	N/A
Beater Diameter	36"
Beater Speed	420 RPM
PTO Speed	1000 RPM
Apron Chain Link Dia.	3/4"
Shipping Weight	19,890 lbs. / 9,022 kg.
Required Tractor PTO HP	200
Brakes Available	Yes

Conditioners

Accumulator

Grabbers

Bale Wagons

Wrappers

Processors

Spreaders

NITRO 950TRI



Specifications	Nitro 950TRI
Carrying Capacity	25 Ton
Heaped (cu. ft.) (with Optional Silage Extension)	1,028 1,252
Struck Level (cu. ft.) (with Optional Silage Extension)	695 918
Inside Dimensions (Inside width between flare 102.5")	67"W x 58"D x 297"L
Overall Length	35.25'
Overall Outside Width (Tri Axle)	155"
Loading Height (Tri-Axle) (with Optional Silage Extension)	108" 124"
Wheel Hub Capacity (Tandem Axle)	16,000 lbs. (10 bolt) x6
Tandem Tire Sizes	750/60-30.5 Floatation or 750/60-30.5 Floatation (Radial)
Wheel Hub Capacity (Single Axle)	N/A
Single Tire Sizes	N/A
Beater Diameter	36"
Beater Speed	420 RPM
PTO Speed	1000 RPM
Apron Chain Link Dia.	3/4"
Shipping Weight	22,340 lbs. / 10,133 kg.
Required Tractor PTO HP	200
Brakes Available	Yes

NITRO 1050



Specifications	Nitro 1050
Carrying Capacity	30 Ton
Heaped (cu. ft.) (with Optional Silage Extension)	1,159 1,509
Struck Level (cu. ft.) (with Optional Silage Extension)	769 1,159
Inside Dimensions (Inside width between flare 102.5")	67"W x 58"D x 324"L
Overall Length	39.25'
Overall Outside Width (Tri Axle)	155"
Loading Height (Tri-Axle) (with Optional Silage Extension)	108" 124"
Wheel Hub Capacity (Tandem Axle)	16,000 lbs. (10 bolt) x6
Tandem Tire Sizes	750/60-30.5 Floatation or 750/60-30.5 Floatation (Radial)
Wheel Hub Capacity (Single Axle)	N/A
Single Tire Sizes	N/A
Beater Diameter	36"
Beater Speed	420 RPM
PTO Speed	1000RPM
Apron Chain Link Dia.	3/4"
Shipping Weight	25,755 lbs. / 11,682 kg.
Required Tractor PTO HP	200+
Brakes Available	Yes

Conditioners

Accumulator

Grabbers

Bale Wagons

Wrappers

Processors

Spreaders

Nitro Features



Hydraulic-Driven Apron Chain

The variable speed apron chain ensures that your load is delivered to the beaters at the right speed regardless of the material consistency. This provides accurate control when metering, application speed, and thickness.

The Nitro is equipped with a fully reversible apron drive. This allows the load to be backed away from the beater assembly should foreign objects such as rocks get in-between the beaters and jam them.



Apron Chain

The brute strength of the Nitro's apron chain system sets it apart. Truly heavy-duty, the chain and sprocket are designed to move heavy loads day after day without chain breaks.



Galvanized Slats

Apron slats are attached to the chain using a heavy tab and slot design. This free floating design minimizes stress on the joints.



Grade 80 - 3/4

Breaking Strength
113,200 lbs.

950

950TRI

1050

Grade 80 - 5/8

Breaking Strength
72,400 lbs.

450 275RS

600 375RS

750 575RS

725RS

Nitro Features



Robust and Dynamically Balanced

Centered on a robust 8-5/8" auger, the Nitro beaters are dynamically balanced ensuring minimal flex and vibration when running the beaters at full speed.



Replaceable Reversible Knives

Every Nitro model is equipped with durable AR400 knives. Each knife can be easily reversed or replaced when required.



Beater Wedge

A standard feature on 275RS, 375RS, 575RS, 450, and 600 models (not required on other models), the beater wedge helps to ensure manure is delivered to the beaters preventing large clumps from falling off the back of the unit.



Quick-Drop Removable Beat

The quick-drop removable beaters remove in minutes converting your spreader into a rear discharge trailer for stockpiling or windrowing. A rear PTO shaft allows you to easily disconnect the gear box from the beater assembly.



Guillotine Endgate

The guillotine endgate can be opened partially to meter the amount of material being delivered to the beater assembly. This ensures the optimal delivery of lime and various manure consistencies to the field.

Nitro Features



Slip Slide Poly Boards

Commercial Models Only

To resist corrosion, the Nitro box is built with slip slide poly boards, with floors measuring in at 1" and walls at 3/4". All poly boards are secured with stainless steel hardware.



CV Shaft

All Nitro models come equipped with a CV (Constant Velocity) Shaft allowing for tighter turning.



Central Grease Banks

Centrally located grease banks ensure easy lubrication of components located in hard to reach areas.



Industrial Jack

The strong, industrial jack, is easy to use and makes unhitching safer.

Driveline Protection

(Standard on all models)

Nitro spreaders are equipped with both an over running clutch and a torque limiter. The over running clutch allows the beaters to freewheel after the tractors PTO drive is shut down. This prevents hard stops reducing the wear on both the Nitro and your tractor.

To prevent damage to beater assemblies, a torque limiter connects the rear PTO shaft and the beater assembly. The torque limiter disengages the driveline from the beaters should the pressure build.



Nitro Options



Suspension Tongue

*Optional on 450, 600, 725 & 750 Models
Standard on 950, 950TRI & 1050 Models*

The suspension tongue provides operator comfort and reduces mechanical stress and fatigue of both the spreader and the tractor.



Silage Extensions

*Optional on 725, 750, 950,
950TRI & 1050 Models*

The Nitro can easily double as a silage hauler, with the addition of optional height-extenders.

Note: Not for use with manure.



Available Colours

Optional

In addition to the standard yellow, the Nitro lineup is available in red, green, blue and orange.



Paddle Kit

Optional

The optional bolt on paddle kit cups material to provide better throw.



Endgate Opening Gauge

Optional

With the endgate opening gauge you can quickly and easily see how open your end gate is in inches.

Nitro Options



LED Lights

Optional

LED lights and flashers ensure transit safety. Innovative light covers mechanically open and close in sequence with the end gate, ensuring lights are protected while spreading.



Rubber Seal Kit

Optional

The Rubber Seal Kit adds a compression seal to the front panel and endgate to help contain semi solid materials.



Oscillating Ball Hitch

Optional

Optional on all models is the articulated ball hitch available in various pin sizes.

Axle and Wheel Availability

Nitro Spreaders can be equipped with either Tri, tandem or single axles and can be placed in one of three mount locations to provide optimal balance.

Tubeline axle and tire combinations distribute the load evenly to reduce ground compaction. Our tandem axles minimize the effects of rough terrain and bumps in the road.

Note: See specifications for single axle availability.



Single Axle Wheels

275RS, 375RS, 575RS, 725RS, 450, 600, 750



425/22.5
Recap Truck

550/45
R22.5

480/70
R30

600/65
R34

710/70
R38

710/70
R42

Tandem Axle Wheels

275RS, 375RS, 575RS, 725RS, 450, 600, 750, 950, 950TRI, 1050



425 x 22.5
Recap Truck

550/45
R22.5

700/50
R26.5

750/60
R30.5

**Also used
for Tri-axle
spreaders*

Note: Tire scaling is approximate.



Consistent Loading Height

Single & Tandem Axles

Each axle is specifically engineered to match the selected tire size. This attention to detail ensures that each spreader that leaves our plant can be easily loaded.



Brakes

Optional for Single & Tandem Axles

The optional brake system comes with a total of 4 calipers. Single axle spreaders are configured with two calipers per rotor. Tandem axle spreaders are configured with one caliper per rotor.

Single axle shown. Braking configurations may vary with model.



Adjustable Axle Position

Commercial Models Only

Our Commercial Series spreaders have 3 axle positions which help to optimize the spreaders balance while traveling through the field.



High Load Bearings

Standard on Tandem Axles

The walking tandem axle pivot bearings on the Commercial Series use high load composite bearings with embedded lubricant. This eliminates need to grease them when performing routine maintenance.

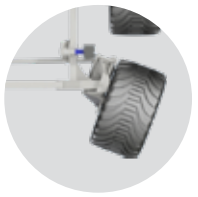

Follow Axles

Tri-Axle Models Only

Front and rear axles allow a of swivel 15° in each directions giving the tri-axle design a great turning radius.



Road Flex Suspension

Tri-Axle Models Only

Wheel independent Road Flex suspension. This patented innovation not only smooths out bumps, it gives added clearance when turning adding even more protection.



NITRO TRI-AXLE

The Tri-Axle has a 16,000 lbs. (10 bolt) wheel hub capacity. Due to the increased amount of contact points, the Tri-Axle results in reduced soil compaction. This allows for more air and water to get to the roots, increasing the yield of your crops when compared to single and tandem axles.

They also come standard with a following axle. The front and rear axles can turn independently, reducing wear on the tires when turning giving your tires longer life.

Brakes are available on Tri-Axle models on both the centre and rear axles. Each axle also comes standard with the Horst Road Flex Suspension system, reducing wear on the NITRO box when driving down the road or in the field.

Tubeline Manufacturing Ltd.

6455 Reid Woods Drive RR#4
Elmira, ON, Canada, N3B 2Z3

Tel. (519) 669-9488
Fax: (519) 669-5808
Toll Free: (888) 856-6613
sales@tubeline.ca
www.tubeline.ca

FOLLOW US ON SOCIAL MEDIA



<https://www.youtube.com/@TubelineMfg>



<https://www.facebook.com/TubelineMFG>